

Presentation

The **DIWATER**, is used to control the desired flow of water in the different spray arms inside a dishwasher. The water flows can be regulated in the lower spray arm, in the upper spray arm, or in all spray arms.

2 Outlets open:
Lower und upper spray arms

1 Outlet open:
Upper spray arm

1 Outlet open:
Lower spray arm

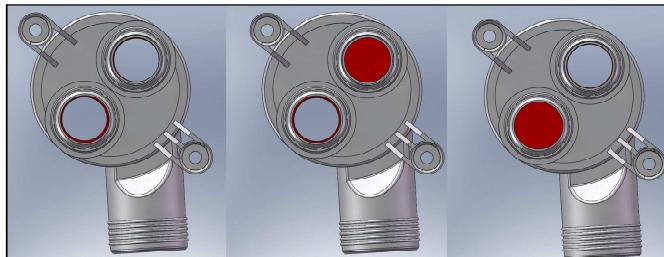

The **DIWATER** allows to:

- wash with a less quantity of water, moving the performance of the appliance versus the *Improved Energy Efficiency Requirements*.
- reduce the noise Level of a dishwasher, giving higher rating of the product in the market.



Technical specifications:

▪ MICROSWITCHES

The switch is welded on a PCB board and activates the motor that turns the diwater in the positions: outlets open, upper outlet open and lower outlet open. To change position, the component needs from 12 to 20 sec. in all positions depending on the motor speed (3 rpm or 5 rpm).

Electrical rating = 5-50 mA / 230 V AC.

▪ GEAR MOTOR

Motor: 230V 50Hz
Rotation Speed: 3 rpm or 5 rpm

▪ ELECTRICAL SCHEME

Connector rast 2.5 at 3 pin
(**Fig.1**)

Pin 1 = microswitch
Pin 2= motor contact
Pin 3= common

Fig.1

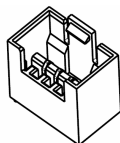
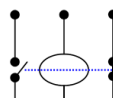

Fig.2

Contatto 1 = switch
Contatto 2= motore
Contatto 3 = switch



Electrical scheme is represented in **Fig.2**

▪ PRESSURE FLOW RATES

Max. flow pressure: 320 mBar
Max. flow rate: 70 l/min. for all spray arms

▪ RELIABILITY

300.000 operating cycles of the gear motor

▪ ENVIRONMENT

Specification	Minimum	Nominal	Maximum
Ambient Temperature (non operating)	-40 F (-40° C)	73 F (22.8° C)	169 F (75° C)
Ambient Temperature (operating)	50 F (10° C)	73 F (22.8° C)	169 F (75° C)
Humidity	20%		
Water Temperature	50 F (10° C)	(120 F a 135 F)	180 F (75° C)

METEOR



METEOR sas
Via S.Anna, 3
I-31010 MARENO DI PIAVE (TV)
Phone +39.0438.4939
Fax +39.0438.493929
info@meteoritaly.com
www.meteoritaly.com
Part.IVA 04255770267